

Hella Mining Products

Morgan Brake



MORGAN[®]





Hella Center Of Excellence - Mining

The Hella Center of Excellence – Mining is dedicated to the support of the global network of over 100 Hella companies, with expert knowledge and product development, sales and marketing resources focused on the unique requirements of the mining industry. Hella produces a comprehensive range of lighting and associated products designed, developed and extensively field tested specifically for use in mining.

The Hella Center of Excellence – Mining is based in Melbourne Australia.

We don't guess, we measure

The development of lighting equipment for mines requires a clear understanding of the operating systems and environmental conditions. At Hella, "We don't guess, we measure." Hella embarked on a research project, "ARGON," to collect data from a diverse range of mines and machines. Hella Center of Excellence – Mining developed a suite of robust sensors with integrated data loggers that mount onto mining plant and machines to record the operating conditions, while the equipment is working as normal. After the sensors are recovered from the machines, the data is downloaded for analysis and is used as the basis for creating product design and test specifications aimed specifically at satisfying the extreme demands of mining environments.

You don't have to guess – you can see before you buy

The Hella Center of Excellence – Mining provides an Applications Engineering lighting design service for Hella Mining customers. The aim of this unique service is to reduce risk to end users and OEMs of implementing an inappropriate lighting design, enabling all stakeholders to evaluate, comment and change the design prior to implementation through computer simulation.



ARGON sensors mounted on a haul truck

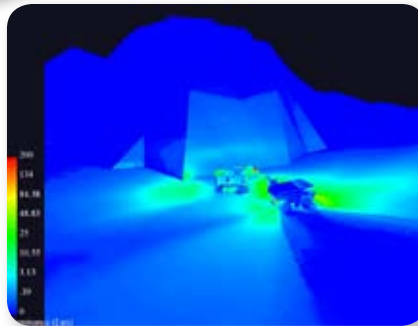

Example light distribution (lux) shown as false color light distribution



Example image from Application Engineering

Key to Icons

Hella Product Features:

- MultiVolt™
- MustADD®
- DRACO®
- MultiFlash™

Configuration:

- Lamp type
- Connection type
- Mass

Electrical:

- Rated voltage
- Power consumption/load

Protection/Hazard Ratings:

- IP rating
- Transient spike protection
- Rated shock resistance
- Hazard Protection Type
- Hazardous Area Classification
- Hazard Area Gas Group Class
- Dust Ignition Proof Class
- Hazardous Temperature Class

Standards Compliance:

- Electrical Compliance
- Public road traffic compliance type

AS500® FF Xenon Heavy Duty Work Lamps



Shown with Trunnion Bracket

AS500® FF Xenon is a compact and highly versatile, ultra heavy-duty Work Lamp for use on mining machinery, suitable for 12V and 24V electrical systems.

Description	Part No.
Wide Beam 24V	HMADX35WBA
Narrow Beam 24V	HMADX35NBA
Wide Beam DT Plug 24V	HMADX35WBD
Narrow Beam DT Plug 24V	HMADX35NBD
Wide Beam 12V	HMAKX35WBA
Narrow Beam 12V	HMAKX35NBA
Wide Beam DT Plug 12V	HMAKX35WBD
Narrow Beam DT Plug 12V	HMAKX35NBD



Multi-adjustable trunnion bracket ensures accurate and stable aiming in a high vibration environment in all assembly positions. Bracket locates the axis of rotation in the centre of gravity

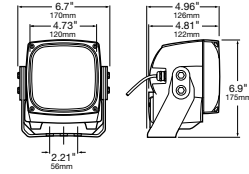

Spare Part

Part No.	Description
HM8164	Clear Protective Cover AS500
9.HMAPEDL	Pedestal Mounting Bracket Assembly
9.HMATRUN	Trunnion Mounting Bracket Assembly
9.HMAWHKD	Cable harness kit AS500
9.HMASXWB	Insert – Wide Optic – AS200/500 GDL
9.HMASXNB	Insert – Narrow Optic – AS200/500 GDL
9.HM151BAL	Multivolt Ballast
XN4000	Bulb – Xenarc D2S

AS500® FF Xenon Work Lamp - Amber



Shown with Trunnion Bracket

Wide beam AS500® FF Xenon Work Lamp fitted with amber colored lens. Double insulated silicone supply cable with DT plug. Specifically designed for low visibility or high glare environments with extreme fog or snow.

Description	Part No.
Wide Beam DT Plug 24V, Amber	HMADX35WBDAMB
Wide Beam DT Plug 24V, Amber, Pedestal	HMPDX35WBDAMB

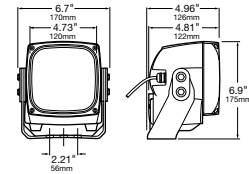

Spare Part

9.HMASXWBAMB	Wide Beam Insert - Amber
--------------	--------------------------

AS500® FF Xenon Work Lamp - Yellow Light



Shown with Trunnion Bracket

Wide beam AS500® FF Xenon Work Lamp fitted with yellow D2S capsule. Double insulated silicone supply cable with DT plug. Specifically designed for low visibility or high glare environments with extreme fog or snow.

Description	Part No.
Wide Beam DT Plug 24V, Yellow D2S	HMADX35WBDYEL

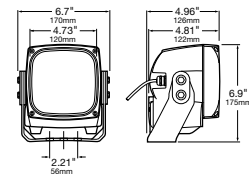

Spare Part

HMXN4YEL	Yellow D2S Xenon Capsule
----------	--------------------------





DuraLed® SAE Signal and Marker Lamps

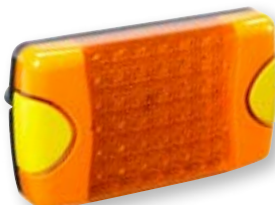

DuraLed® lamps feature unique designs with shallow shapes and concealed mounting screws for enhanced protection against damage. All lamps are pre-wired with multi-core sheathed cable, fully sealed against dust and moisture to International Protection Standards IP6K6 and IP6K7, and are compliant with current SAE regulations.

Description	Part No.
Stop/Tail Rear Turn Signal (Red)	HM060321
Rear Turn Signal/Indicator (Amber)	HM070321

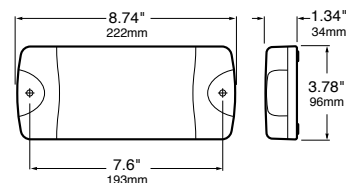

DuraLed® M Marker Lamps



DuraLed® M "Fit and Forget" robust waterproof clearance marker and inspection lamps utilize the latest LED technology specifically for heavy duty applications. DuraLed® M signal lamps feature the Hella pioneered Multivolt™ system that ensures the same ultra bright light output at supply voltages between 8V DC and 28V DC.

Description	Part No.
Red Marker	HM2307
Amber Marker	HM2051
Red Marker DT Plug	HM2307D
Amber Marker DT Plug	HM2051D

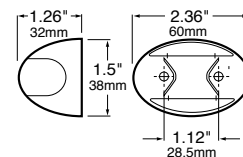

Marker Lamp displayed in OFF mode. Optics on all Marker Lamps appear clear until illuminated.

Spare Part
9.HMDLM002 Marker Housing Yellow (Pack of 4)

EuroLED® Touch M Interior Lamp



EuroLED® Touch M interior lamps are equipped with high-performance LEDs – a single white LED in the center of the lamp plus multiple red LEDs arranged in a circular pattern – and highly advanced lens optics providing a uniform light distribution without glare for optimum efficiency and increased safety.

Description	Part No.
2.5m cable	HM959950211
0.5m cable DT Plug	HM959950221

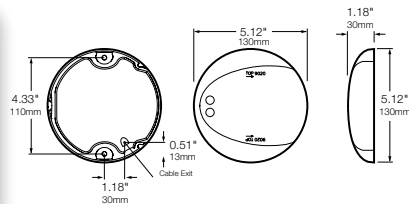
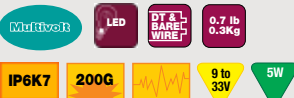

5-3/4" High/Low Beam Conversion Headlamp

This product is NOT for mining applications



The 5-3/4" High/Low beam conversion headlamp is ideal for retrofitting and replacing old sealed beam lighting technology. Single lamp fits left or right and produces a more powerful beam on low beam and high beam.

Description	Part No.
5-3/4" High/Low Beam Conversion Headlamp Single	002850871
H4 Bulb, 55W	H83135051

H3 Halogen Premium High Performance Long Life Bulb

The H3 Halogen Premium High Performance Long Life Bulb is 24V, 70W and has a rated life expectancy of 1200 hours.



Description	Part No.
H3 Halogen Premium High Performance Long Life Bulb	YC2470LTS

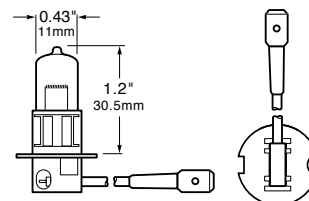



UltraRay® LED Warning Beacons

UltraRAY® LED Warning Beacons



UltraRAY® LED warning beacons are optimized for continuous use applications on mining equipment, to ensure highly effective warning efficiency in daylight on surface operations in the extreme environmental conditions encountered in mining applications.

UltraRAY® LED beacons offer multiple, user-selectable flash patterns to suit a large variety of applications. Additional user selectable features include a battery saver mode to alert users if the equipment power supply drops below normal operating voltage levels to conserve power, as well as a daylight sensing that can automatically adjust the intensity of the beacon to ambient light levels. A reverse gear circuit allows the flash pattern to be changed to alert staff of the travel direction of the equipment. The desired operational mode can be selected by simply changing the DIP switch settings on the circuit board.

UltraRAY beacons are extremely robust, tolerant to severe vibration levels and very compact in design. Each beacon is equipped with a high impact and shock-resistant, clear polycarbonate lens bolted to a heavy-duty cast alloy base, sealed by a neoprene O-ring against dust and water ingress. A UV resistant multi-stage powder coating process ensures optimal corrosion protection.

Unlike Xenon flash strobes, UltraRAY® LED beacons are maintenance free and extremely power efficient, which greatly reduces both operating temperature and demand on the vehicle's electrical system. Maximum service life and light output of the high intensity LEDs is ensured through integrating the heat sinks into the cast alloy base. The Multivolt™ control module encapsulated directly into the base also protects the UltraRAY® against damage from overheating, reverse polarity and short circuits. (See technical section for more Multivolt™ information.)

Safe and reliable electrical connection is facilitated via a highly flexible double insulated cable sealed into the base, terminated as a short length with a DT connector or 2m cable with bare wire ends. Other connector options can be supplied as special orders.

UltraRAY® beacons are available in five LED signal colors (amber, red, blue, green and white) to suit all signal applications. Installation is possible with either the standard direct mount or an optional pipe mounting kit. Temporary use applications are best served with the magnetic mount version, complete with a pre wired cable and power plug.

Description	Part No.
AMBER	
Direct Mount	HM400ADIR
Magnetic Mount	HM400AMAG

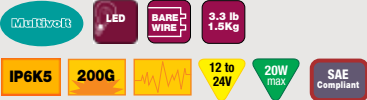

Spare Parts

9.HM400LENS	Clear Lens
HM400PIPE	Pipe Mount Kit

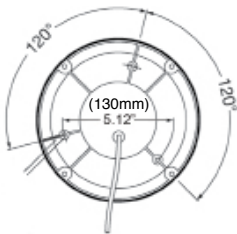
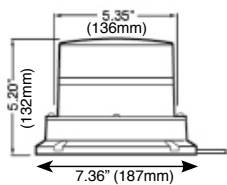

Product features

- SAE J845 Class 1 red & amber
- Available in amber, red, blue, green and white
- User selectable flash patterns (4)
- Automatic daylight detection
- Impact resistant smooth polycarbonate lens
- Clear precision Fresnel optics
- Cast alloy base
- Direct, pipe mount or magnetic installation options
- Multivolt™ 12–30V DC
- Low current draw
- Fully encapsulated electronics
- 3.3 lb (1.5kg) mass
- 200G shock impulse resistant
- Overheat, reverse polarity and short circuit protection
- Double insulated supply cable with DT or AMP plug
- O-ring seals
- Tested over a –20°C to +50°C temperature range
- High efficiency, long life LED light
- IP6K5
- 200G shock resistant

K-LED 360 E LED Warning Beacon



The K-LED 360 E Warning Beacon has aluminum LED mounting towers that ensure efficient heat dissipation for maximum brightness and longer life from its 6x high power CREE LEDs. Its magnetic mount features 190lb pull force and 10ft flat cable with switched lighter plug and "on" indicator.

Description	Part No.
Magnetic multi-voltage white LEDs, amber lens	H27071111

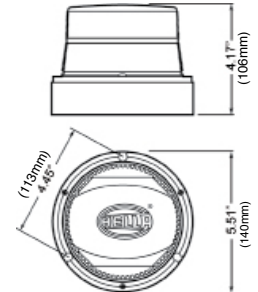

Power Beam 1000 LED Work Lamp



Above: Shown with Heavy Duty Bracket

The Power Beam 1000 is a Multivolt (9-33V) LED Work Lamp with minimal power consumption (18 Watts). It has a long service life with 6 high performance LEDs and an optional Heavy Duty bracket.

Description	Part No.
Work Lamp with DT Connector, Glass Lens	996188001
Work Lamp with DT Connector, Glass Lens and HD Bracket	996188011
Work Lamp with DT Connector, PMMA Lens	996188021
300mm - 11.8" Pigtail with 2 Pin DT Connector	H84985241

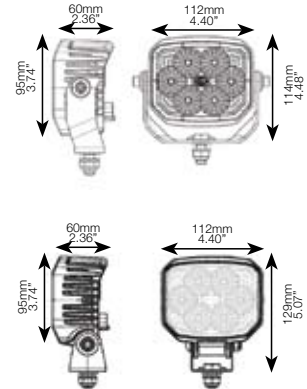

Power Beam 2000 LED Work Lamp



The Power Beam 2000 is a Multivolt (9-33V) LED Work Lamp with a light color similar to daylight. Using 16 LEDs it has a service life of 16,000 hours.

Description	Part No.
Power Beam Work Lamp, PMMA Lens	996189001

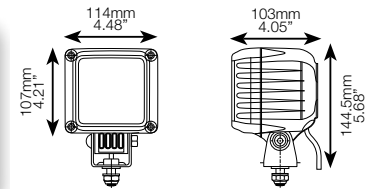

The products on this page are NOT for mining applications



© Hella, Inc. 12.10 Printed in USA

Morgan Brake & Clutch Company

Edmonton AB (780) 484 - 7001 kcalvert@morgan.ca
Richmond BC (604) 247 - 0035 sales@morgan.ca
Sparwood BC (250) 425 - 2538 mhuryn@morgan.ca
Pr. George BC (250) 561 - 2448 sales@morgan.ca
www.morgan.ca

